



Curved Nozzle Kit

For D/F Water-Cooled MIG Pistol Grip Gun

D/F MACHINE SPECIALTIES
1750 Howard Drive
North Mankato, MN 56003
Ph: (507) 625-6200
Fax: (507) 625-6203

The D/F Curved Nozzle Kit is readily adaptable to the Semi-Automatic MIG Water-Cooled Pistol Grip Gun to extend the Water-Cooled Nozzle for easy access to hard to reach weld locations. This kit employs a bent slip-in current tip and accommodates 3/64" & 1/16" AL wire, and .035"-1/16" hard/cored wires.

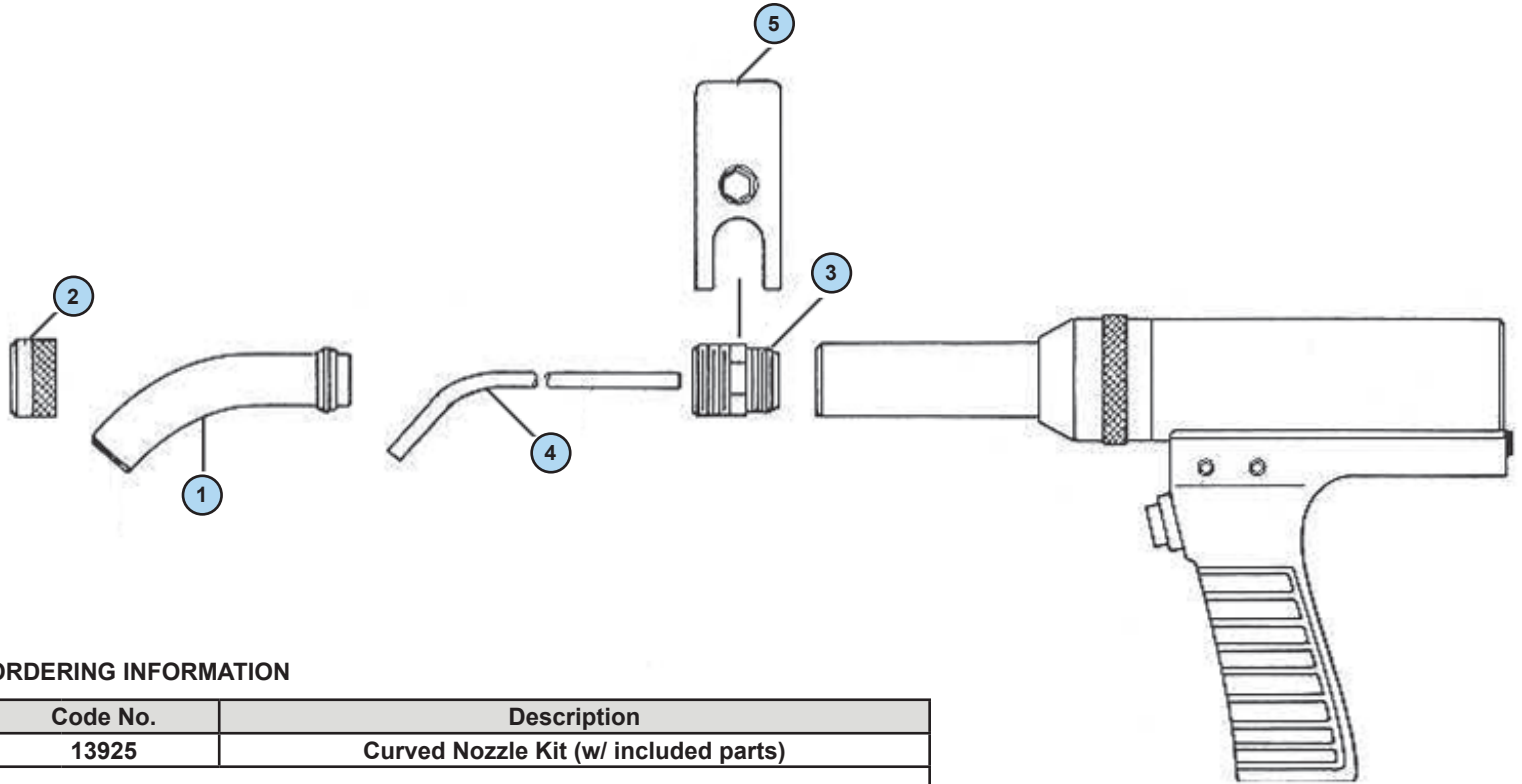

ORDERING INFORMATION

Code No.	Description	
13925	Curved Nozzle Kit (w/ included parts)	
INCLUDED PARTS IN CURVED NOZZLE KIT:		
Ref.	Code No.	Description
1	10365	Curved Gas Nozzle
2	13926	Lock Nut
3	13927	Adapter
4	15061	Bent Current Tip .035" Hard (5 ea.)
	15062	Bent Current Tip .045" Hard (5 ea.)
	15063	Bent Current Tip 1/16" Hard (5 ea.)
	15072	Bent Current Tip 3/64" AL (5 ea.)
	15073	Bent Current Tip 1/16" AL (5 ea.)
5	12116	Wrench

INSTALLATION

To adapt the Curved Nozzle, proceed as follows:

1. Remove the existing Gas Nozzle, Current Tip and Collet Nut from the Water-Cooled Nozzle.
2. Fasten the Adapter (13927) using the Wrench (12116) into the forward end of the Water-Cooled Nozzle.
3. Place the Collet Nut on the Bent Current Tip and tighten to provide access to welding condition desired.
4. Slide the Curved Nozzle (10365) over the Bent Current Tip until it engages in the Adapter. Fasten the curved end of the Curved Gas Nozzle by tightening the Lock Nut (13926). Observe the latter carefully so that the curved nozzle remains concentric to the Bent Current Tip.